

East Allen County Schools Highland Terrace Elementary

October 18, 2011

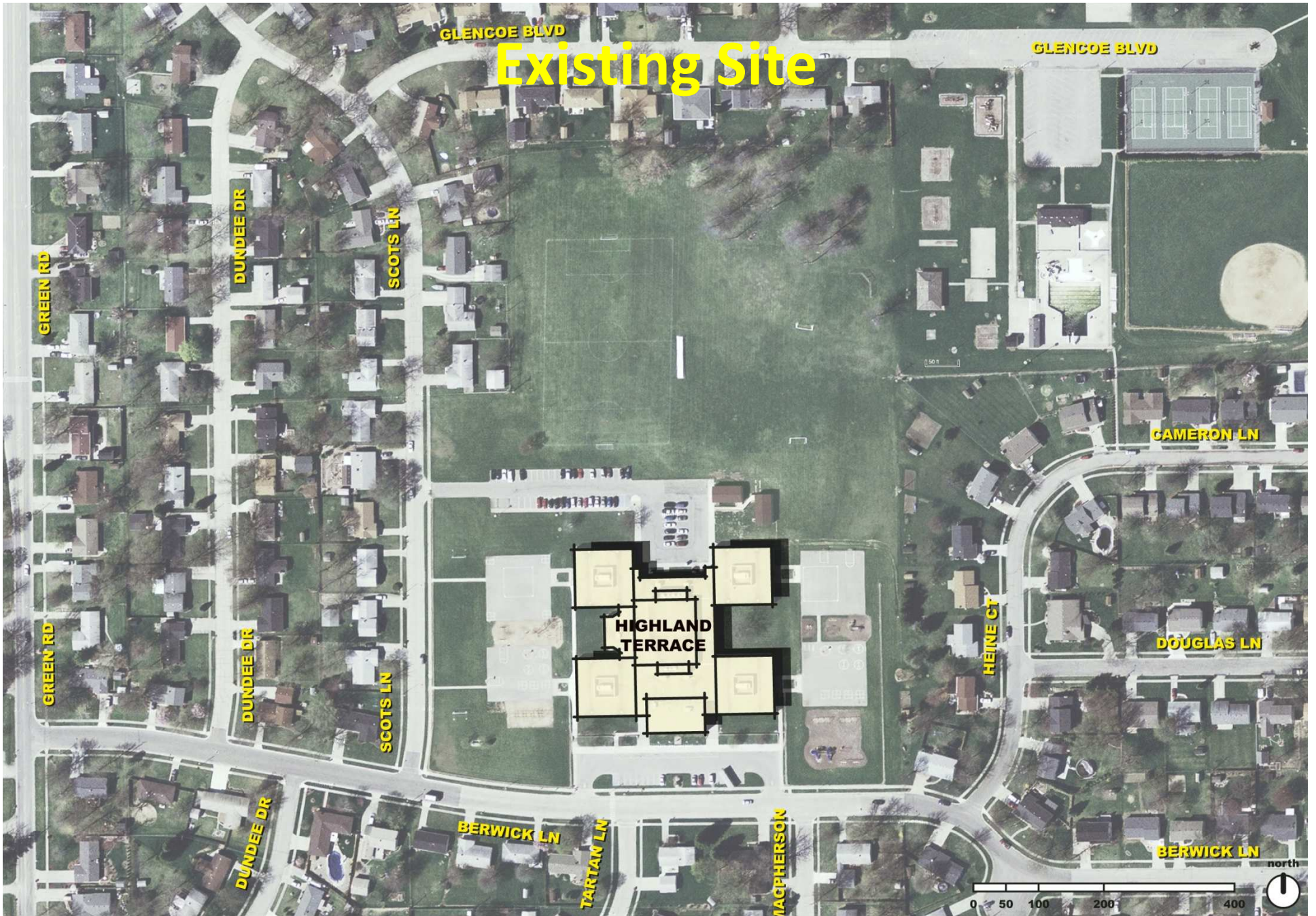

BARTON · COE · VILAMAA
ARCHITECTS · ENGINEERS



Existing Site

Existing Building Use

Intense Inter.

Grade 2

Grade 1

Grade 1

Mild Inter.

Grade K

Grade K

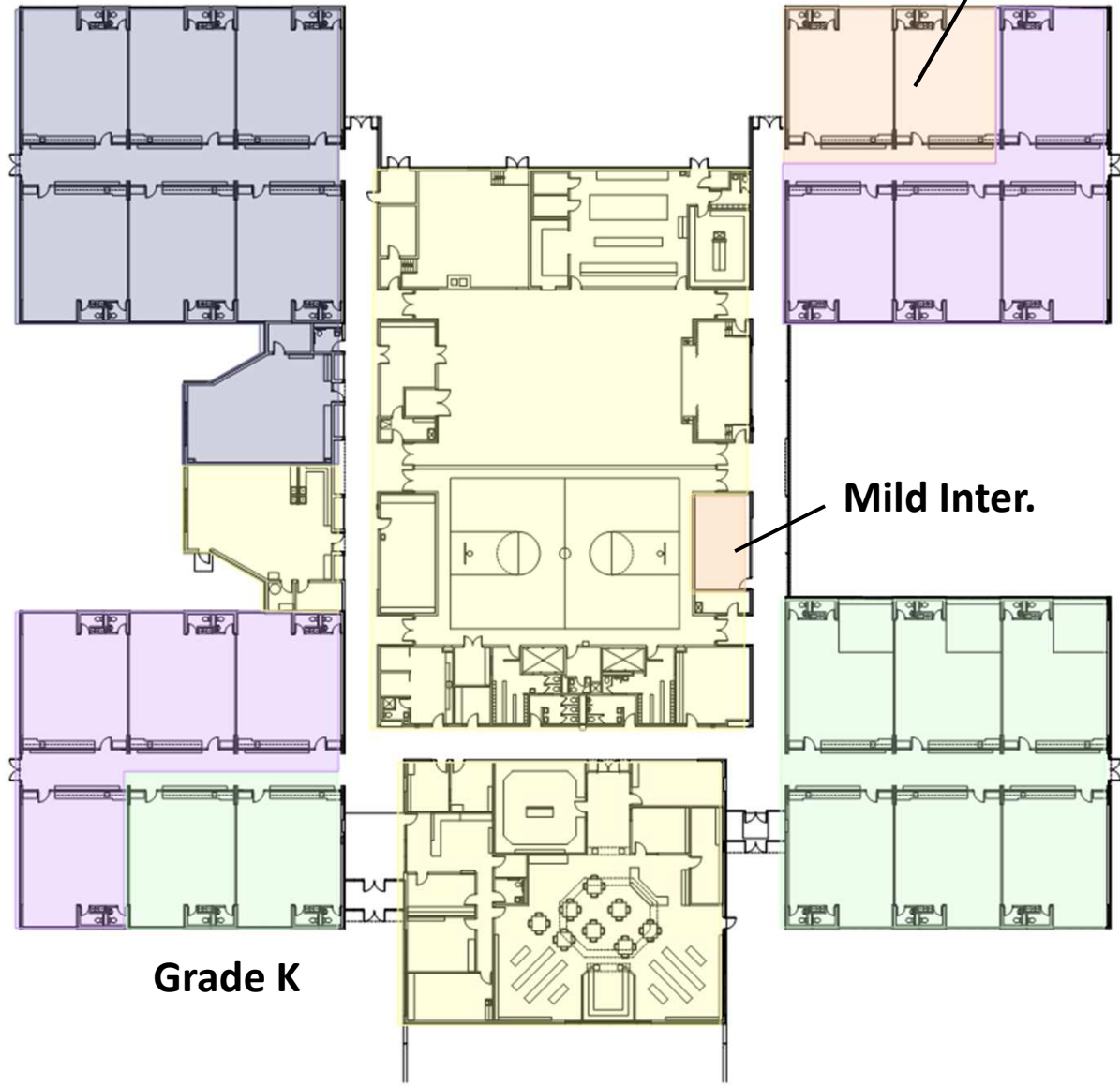

Program of Spaces

Current Building Use and Deficiencies

- 23 Classrooms Grades K, 1, 2
- Currently using Music for classroom
- Intervention spaces not properly designed
- Long traffic back-ups at PM pick-up
- Insufficient parking for volunteers & visitors

Immediate Building Needs

- Address traffic and parking needs
- Two (2) General Education PreSchool Rooms
- Create appropriate Intervention spaces

Future Building Needs

- Four (4) Special Education PreSchool Rooms
- Physical & Occupational Therapy Rooms
- Replace Music Room

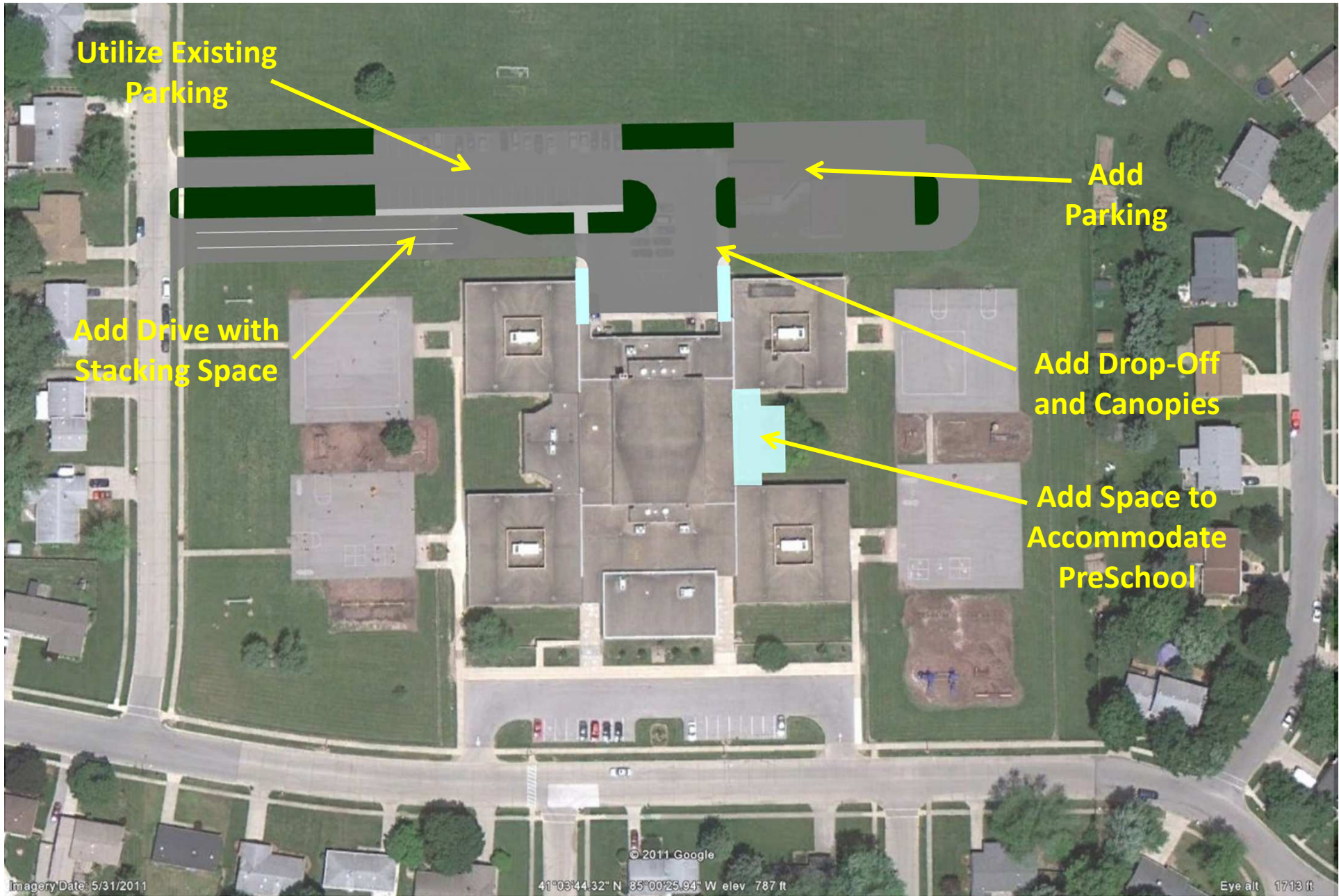

Schematic Design

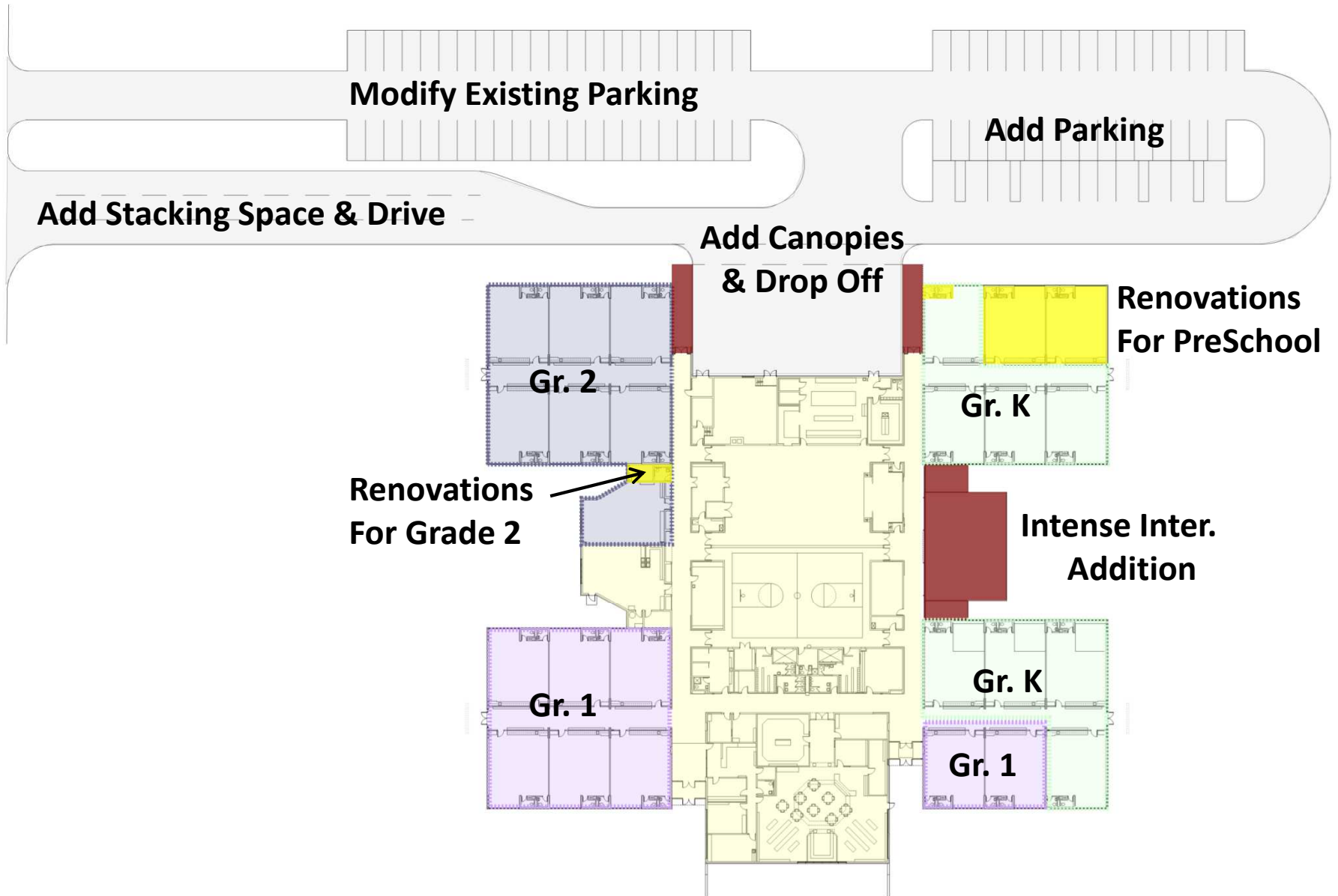

Questions

East Allen County Schools Highland Terrace Project Estimated Project Budget

Construction Costs	\$ 1,300,000
Non-Construction Costs	<u>105,800</u>
Estimated Project Cost	\$1,405,800
Capital Projects Fund	\$1,405,800

Note: CPF currently has an encumbrance of \$1,680,000 for Highland Terrace