

East Allen County Schools Highland Terrace Elementary Project Update

October 4, 2011

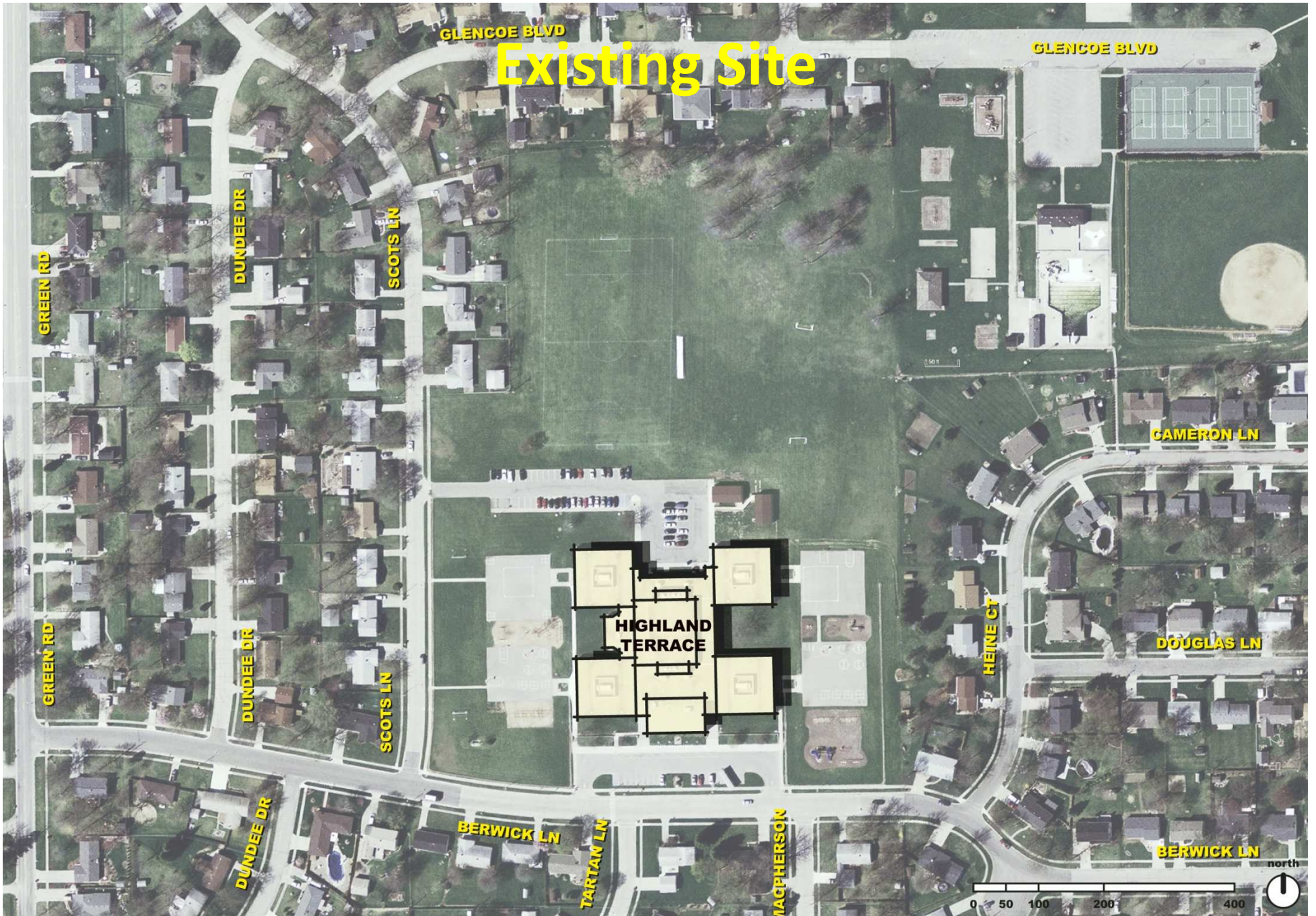

BARTON · COE · VILAMAA
ARCHITECTS · ENGINEERS



Existing Site

Existing Building Use

Intense Inter.

Grade 2

Grade 1

Grade 1

Mild Inter.

Grade K

Grade K

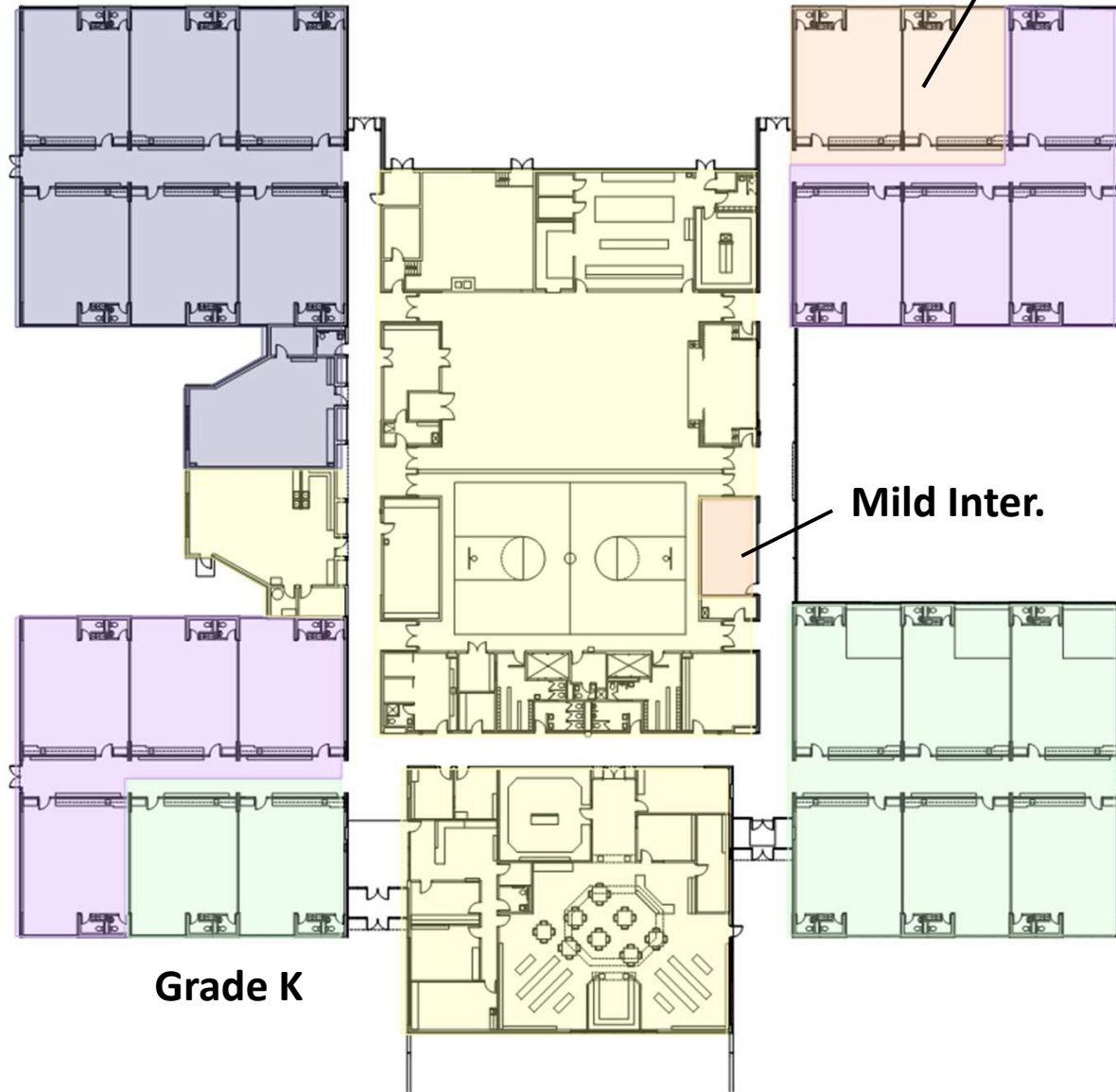

Program of Spaces

Current Building Use and Deficiencies

- 23 Classrooms Grades K, 1, 2
- Currently using Music for classroom
- Intervention spaces not properly designed
- Long traffic back-ups at PM pick-up
- Insufficient parking for volunteers & visitors

Current Building Needs

- Address traffic and parking needs
- Two (2) General Education PreSchool Rooms
- Replace Music Room
- Create appropriate Intervention spaces

Future Building Needs

- Four (4) Special Education PreSchool Rooms
- Physical & Occupational Therapy Rooms

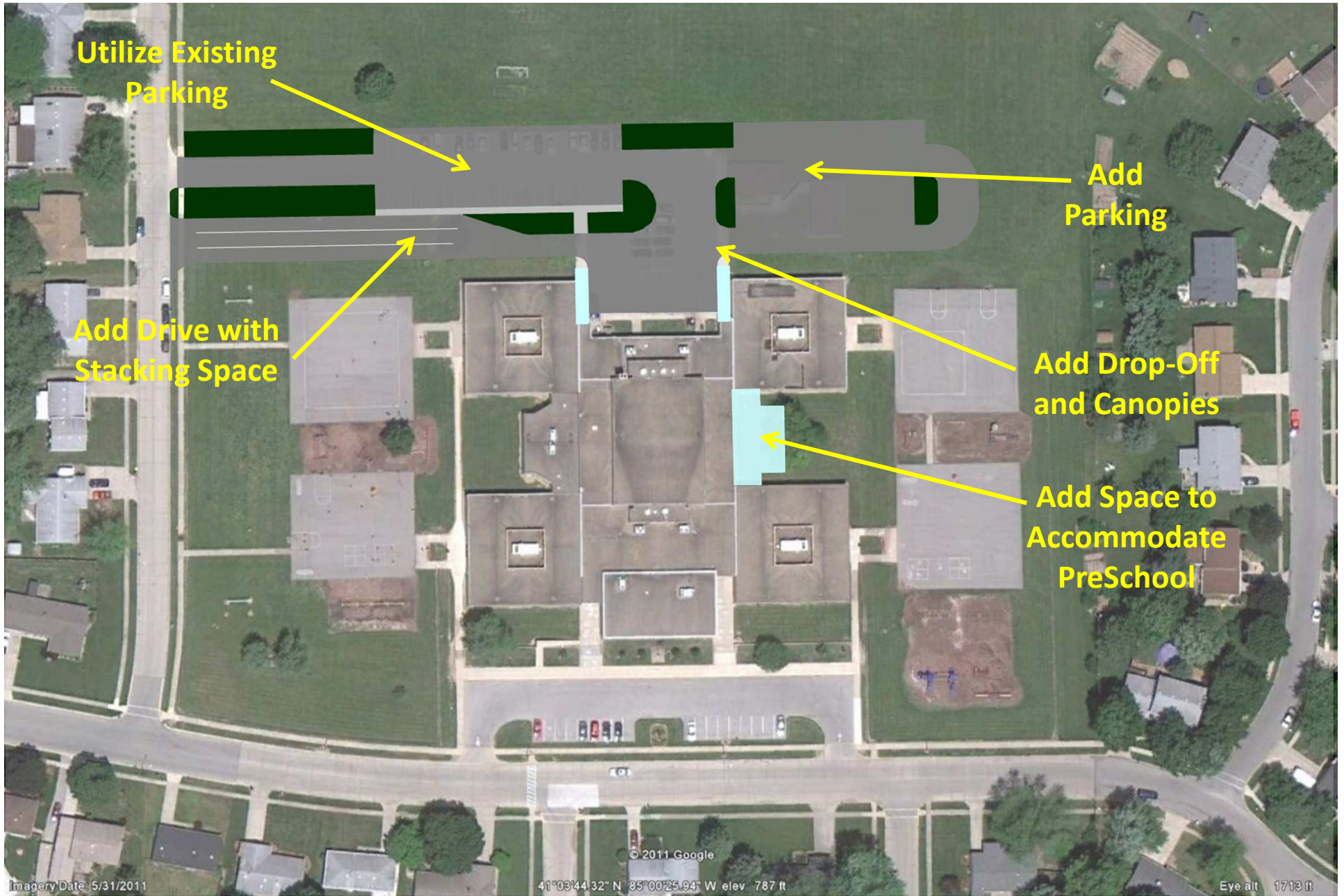

Schematic Design

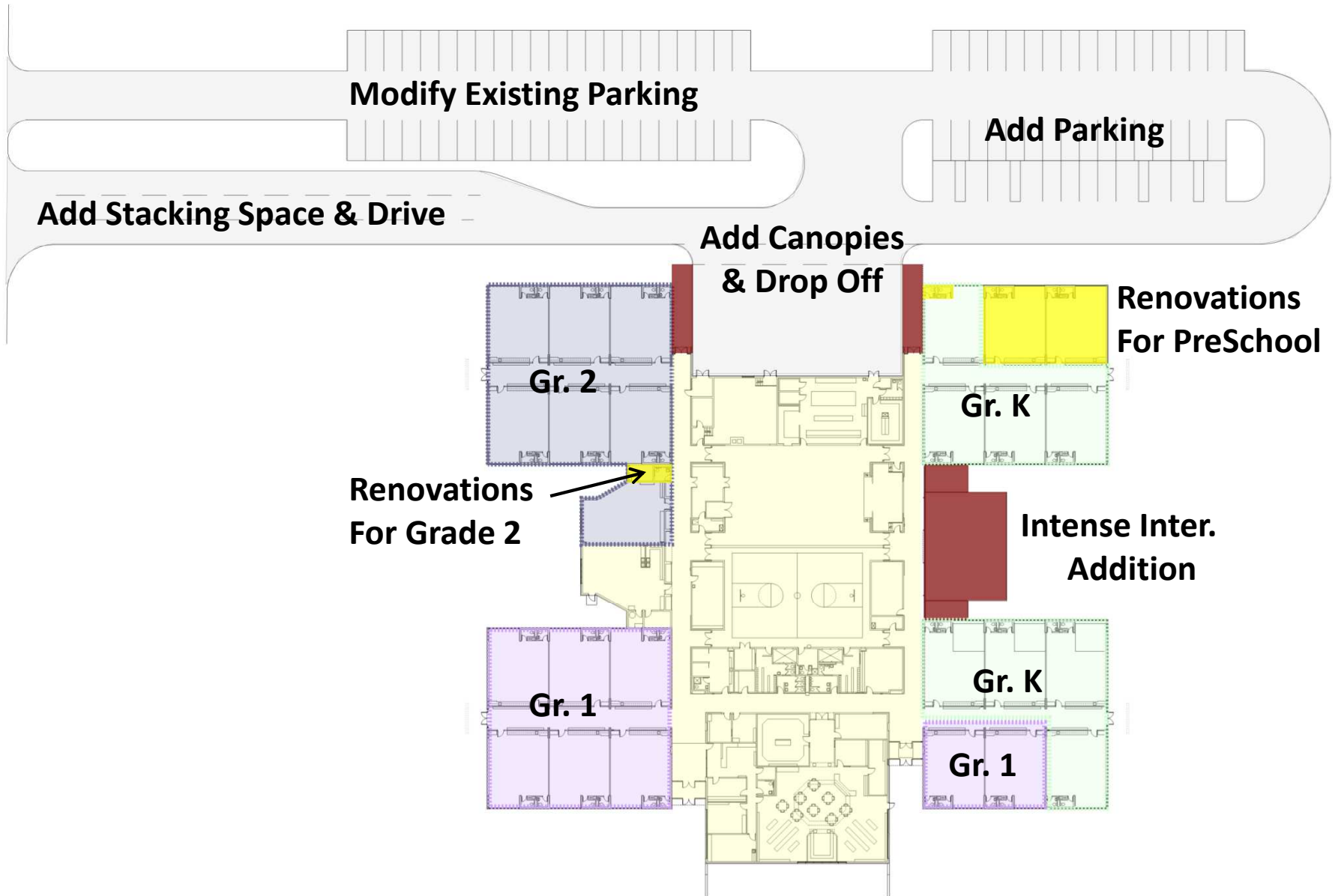

Estimated Construction Costs

Renovation / New Construction \$ 650,000

Parking / Drive / Walks / Etc. \$ 640,000

Questions